

**Product number C12771\_RER-7-S**

Family	Tampa	FWHM	19 degrees
Type	Lens array	Efficiency	89 %
LED	LUXEON Rebel ES	cd/lm	4.429
Color	Clear	Gerber File	Available
Diameter	38 mm		
Height	10.6 mm		
Style	Round		
Optic Material	PMMA		
Holder Material	-		
Fastening	["pin", "glue"]		
Status	Production ready		

**Product number C11232\_RER-7-MD**

Family	Tampa	FWHM	36 degrees
Type	Lens array	Efficiency	85 %
LED	LUXEON Rebel ES	cd/lm	-
Color	Clear	Gerber File	Available
Diameter	38 mm		
Height	10.6 mm		
Style	Round		
Optic Material	PMMA		
Holder Material	-		
Fastening	["glue", "pin"]		
Status	Production ready		

**Product number C11230\_RER-7-W**

Family	Tampa	FWHM	42 degrees
Type	Lens array	Efficiency	82 %
LED	LUXEON Rebel ES	cd/lm	-
Color	Clear	Gerber File	Available
Diameter	38 mm		
Height	10.6 mm		
Style	Round		
Optic Material	PMMA		
Holder Material	-		
Fastening	["pin", "glue"]		
Status	Production ready		

**Product number C11231\_RER-7-WW**

Family	Tampa	FWHM	52 degrees
Type	Lens array	Efficiency	90 %
LED	LUXEON Rebel ES	cd/lm	-
Color	Clear	Gerber File	Available
Diameter	38 mm		
Height	10.6 mm		
Style	Round		
Optic Material	PMMA		
Holder Material	-		
Fastening	["pin", "glue"]		
Status	Production ready		



## PRODUCT DATASHEET

### Tampa series

last update 30/11/2012

**NOTE: The typical divergence will be changed by different color, chip size and chip position tolerance. The typical total divergence is the full angle measured where the luminous intensity is half of the peak value.**



## PRODUCT DATASHEET

### Tampa series

last update 30/11/2012

#### GENERAL INFORMATION

- Product series especially designed & optimized for LUXEON Rebel ES series of LEDs.
- Special care taken to make light distribution as uniform as possible.
- Lens material optical grade PMMA with high UV and temperature resistance. Allows use of high current and temperature conditions.

Please find more information about used material from below:

[http://ledil.fi/sites/default/files/Documents/Technical/Material/PMMA%20N%20UL94\\_Yellow%20Card.pdf](http://ledil.fi/sites/default/files/Documents/Technical/Material/PMMA%20N%20UL94_Yellow%20Card.pdf)

<http://ledil.fi/sites/default/files/Documents/Technical/Material/PMMA%20N%20PLEXIGLAS-Datasheet.pdf>

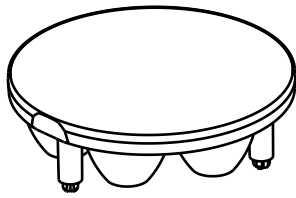

Isometric view  
Scale: 1:1

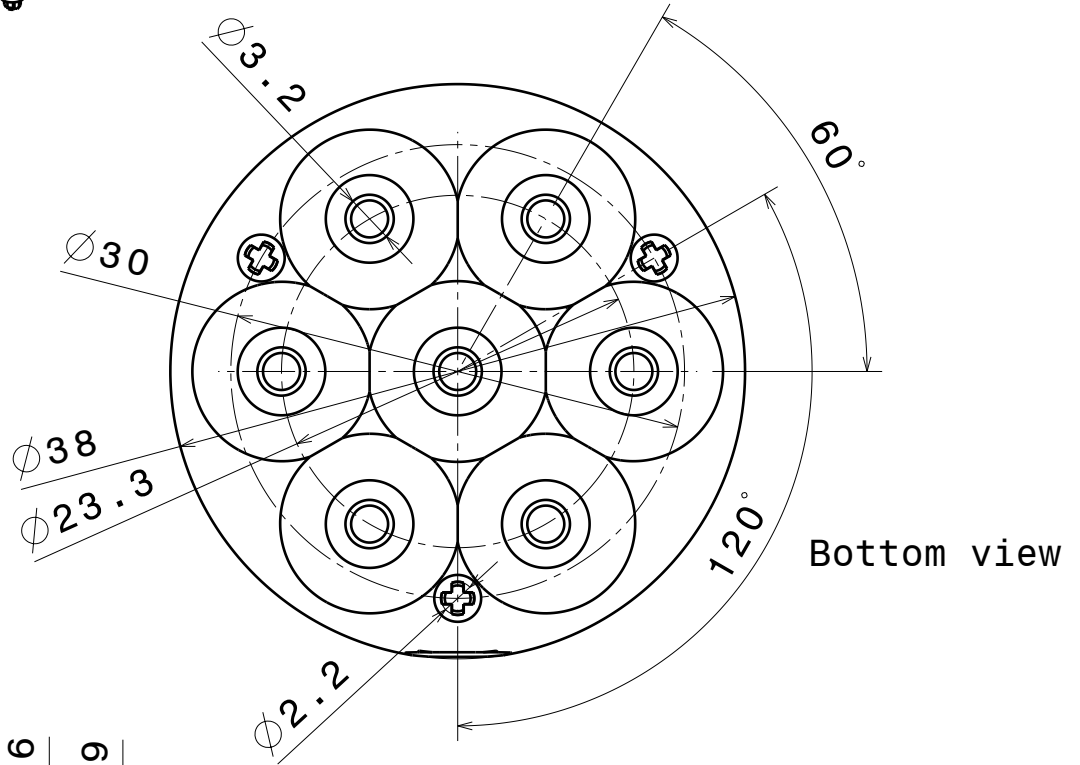

Bottom view

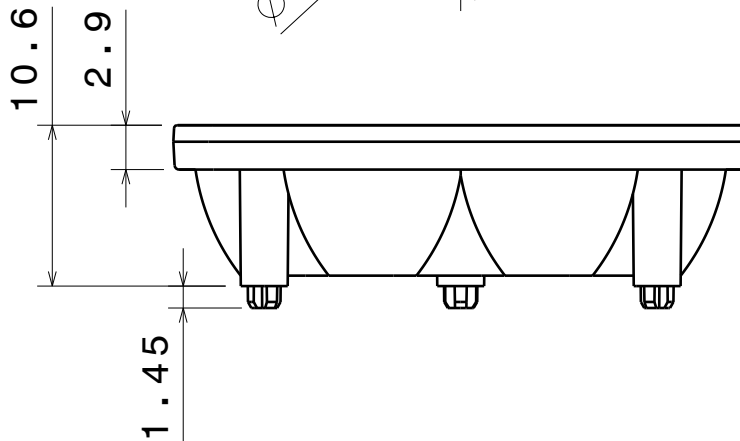

Front view

Material: PC, Lexan 915AU

Tolerances:

Dimensions less < 20mm  $\pm 0.1$ mm

Dimensions between (21-45)mm  $\pm 0.2$ mm

This drawing is our property.  
It can't be reproduced  
or communicated without  
our written agreement.



Ledil Oy  
Salorankatu 10  
FIN 24240 SALO  
Finland

DRAWING TITLE | Mechanical drawing

DRAWN BY  
pv

DATE  
02.11.2010

RER-7 PC

CHECKED BY  
sn

DATE  
-

SIZE PART NUMBER  
A4 -

REV  
001

DESIGNED BY  
hh

DATE  
13.11.2009

SCALE 1:1 WEIGHT - SHEET 1/1